

Ashtons



Apartment 14 Castle Chambers 5 Clifford Street YO1 9RG

£1,600 PCM

2



1



1



C





Located in the heart of the city centre is this well presented modern two bedroom, furnished, second floor apartment. Enter via spacious entrance hall with utility cupboard housing washer/dryer, leading to large open plan living/kitchen with appliances including induction hob, oven, fridge/freezer and dishwasher; main bathroom with shower over bath and two double bedrooms. No onsite parking. Bike storage.

Available Now

Council Tax Band D / 6 month initial tenancy / EPC Rating C / Deposit £1845

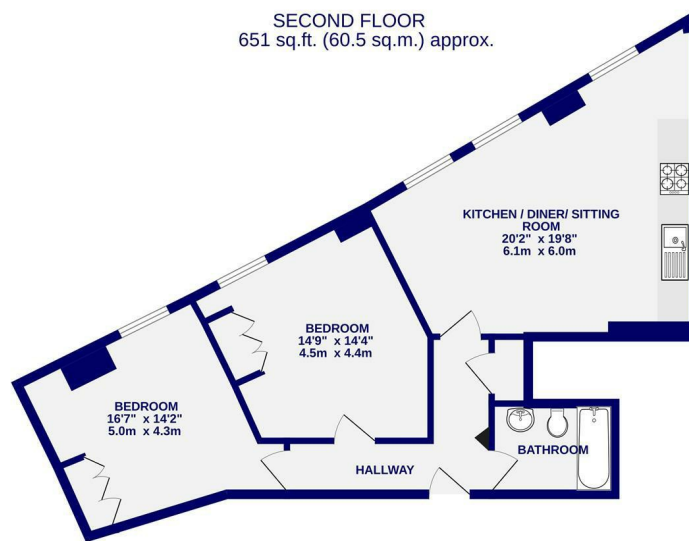

TOTAL FLOOR AREA: 651 sq.ft. (60.5 sq.m.) approx.  
Whilst every attempt has been made to ensure the accuracy of the floorplan, measurements of rooms and any other items are approximate. It is intended that the floorplan will form part of the overall offer and not be responsible for any errors, omissions or misstatements. The plan is for illustrative purposes only and should be used as such by any prospective purchaser. The services, systems and appliances shown have not been tested and no guarantee as to their operability.  
Made with Metrax ©2025



Ashtons Lettings

01904 731404

lettings@ashtonsnet.com

